

SHR7

7" HEADREST WIDESCREEN TFT VIDEO MONITOR

12.2006



SOUND STORM[®]
L A B O R A T O R I E S

3451 LUNAR COURT, OXNARD CA 93030

PHONE: 805.983.8008

FAX: 805.983.7068

TECHNICAL SUPPORT:
www.soundstormlab.com



✓ N1342

User's Manual



SHR7

7" HEADREST WIDESCREEN TFT VIDEO MONITOR



SHR7
*7" Headrest Widescreen
TFT Video Monitor*

**Congratulations on your purchase
of a Sound Storm Video Monitor.**

It has been designed, engineered and
manufactured to bring you the highest
level of performance and quality, and
will afford you years of viewing
pleasure.

Thank you for making Sound Storm
your choice in car video entertainment!

USER'S MANUAL

<i>page</i>	CONTENTS
2	General precautions
2	Safety precautions
3	Installation precautions
3	Operation precautions
4	Features
4	What is included?
5	Monitor controls and features
6	Remote control
6	Remote control battery replacement
7	System wiring
8	Monitor installation
10	Troubleshooting
11	Specifications

General precautions

Please read this manual completely and carefully prior to attempting to install your new **Sound Storm** mobile video equipment. Installed correctly, your **Sound Storm** equipment will provide you with years of enjoyable and safe usage.

Installation of this equipment in any portion of a vehicle which impairs or distracts the driver is improper and dangerous. **Sound Storm** assumes no liability whatsoever for failure to follow the proper installation of this product.

Please keep this manual in a safe place for future reference.

Safety precautions

- Do not operate this equipment while driving – safe driving should always be your highest priority.
- Do not install this product in a location which allows the monitor screen to be visible to the driver of the vehicle. In some states and countries, the viewing of images on a screen inside a vehicle is illegal, even by people other than the driver. Be sure that the installation and operation of this system is in compliance with local rules and regulations.
- Do not open or attempt to repair this unit yourself. Dangerous high voltages are present which may result in electric shock. Refer any repairs to a qualified service technician.
- Do not attempt to repair a damaged, broken or faulty power cord. Replace it with a new one immediately.

- To avoid risk of electronic shock or damage to the monitor, do not permit any of this equipment to become damp or wet from water or drinks. If this does occur, immediately unplug the power cord and send the monitor to your local dealer or service center as soon as possible.

- If there is smoke or any peculiar odor present during use or if there is damage to any of the component enclosures, immediately unplug the power cord and send the monitor to your local dealer or service center as soon as possible.

SHOCK HAZARD! Do not open the case of this product. There are dangerous voltages present within the unit. There are no user-serviceable parts within the unit.

Specifications



MODEL

SHR7

7" Headrest Widescreen
TFT Video Monitor

A/V SYSTEM

Screen size	7"
Screen format	16:9 (wide)
Video Compatability	NTSC/PAL
LCD panel type	Active Matrix TFT
Resolution, pixels	1152 x 234
Brightness	450 NITS

GENERAL

Power requirements	12V DC
Power consumption	9W
Dimensions (L x W x H)	7.7" x 5.0" x 0.9"

All specifications subject to change without notice.

Troubleshooting

If you experience operation or performance problems with this product, compare your installation with the electrical wiring diagram on the previous page. If problems persist, read the following troubleshooting tips which may help eliminate the problems.

SYMPTOM	CAUSE	REMEDY
No picture or sound.	Power cord is not properly connected.	<i>Check that power connections are properly made and all fuses are in functioning condition.</i>
	A/V input cables not properly connected.	<i>Check all cables.</i>
	A/V input source is not operating properly.	<i>Replace or repair A/V source (DVD player, video game, etc.)</i>
No picture.	A/V signal not present.	<i>Check all cables. If necessary, repair or replace A/V source.</i>
	Contrast and/or brightness is set improperly.	<i>Adjust contrast and brightness levels to see if picture appears.</i>
	TV reception is poor (applies to system with TV tuner only)	<i>Check and adjust antenna system. Move to another area with better reception, if possible.</i>
Remote control does not function properly.	Batteries are dead.	<i>Replace batteries.</i>
	Remote is not being used in direct line-of-sight with the player or remote IR sensor. Transmission is best within 6 feet/30° angle of IR sensor on monitor front panel, and within .	<i>Be sure when being used, the remote is being pointed directly toward the player or remote IR sensor (if installed).</i>

Installation precautions

Choose a mounting location in your vehicle where the unit will not distract or otherwise interfere with the driver's ability to control the vehicle.

Do not install components in areas which are susceptible to rain, moisture, direct sunlight, extreme heat or cold, excessive dust, dirt or humidity.

If installation requires drilling holes or other modifications to the vehicle, consult with your nearest dealer or professional car audio installer.

Use only the installation parts and hardware provided with the unit to ensure proper installation. Using other parts can cause malfunction and possible damage to your **Sound Storm** video monitor.

Use only a power source with 12 Volts DC (negative ground).

Before final installation, temporarily connect the wiring according to the diagram near the end of this manual, check it to ensure that it has been connected properly, and test the unit to make sure it is working correctly.

After the monitor is installed, do not arbitrarily pull it down or strike it. This may loosen the mounting screws and cause it to fall down.

Operating precautions

Turn the unit off when it is not in use.

Avoid dropping any metal objects or inflammable items into the monitor ventilation slots.

Do not place objects on or suspend objects from the power cord, as this may damage the cord.

Features

Your new video monitor features the following:

- **TFT Active Matrix LCD display**
- **On-screen menu system**
- **Three AV RCA-type inputs**
- **Wireless remote control**

What is included?

When first unpacking your new flip-down monitor, please check first that the package contains all of the items below. If something is missing, contact the store where you purchased the player.

- **LCD monitor**
- **Mounting shroud**
- **Trim bezel**
- **Wireless remote control with batteries**
- **Power/AV cable**
- **Mounting screws**

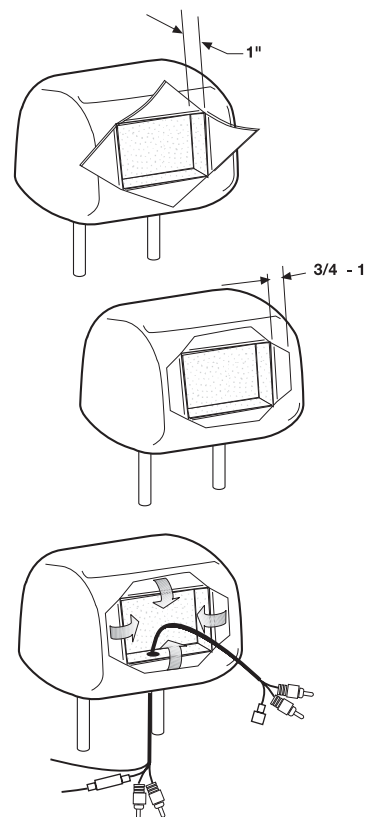

Set the adjustable blade to 1" depth, and cut around the edges of the hole, staying 1/4" inside the edge. Pull up one corner of the foam rectangle, and use the blade to cut underneath – remove a small section at a time, using the "pull up and cut" method for uniform depth. If necessary, use a Dremel tool or other appropriate tool to remove any other obstructions present.

Using a sharp scissors, cut the points off the flaps of upholstery material to about 3/4" - 1" wide.

Route the cable through the opening just cut, and out the bottom of the headrest. If possible, conceal the cable using a gear shift covering or similar. Then fold the four flaps into the cavity in the headrest.

Slide the trim frame onto the monitor shroud and slide the assembly into the cavity in the headrest. As you do this, feed the cable through the headrest as shown in the diagram. Secure the shroud with the three screws as shown.

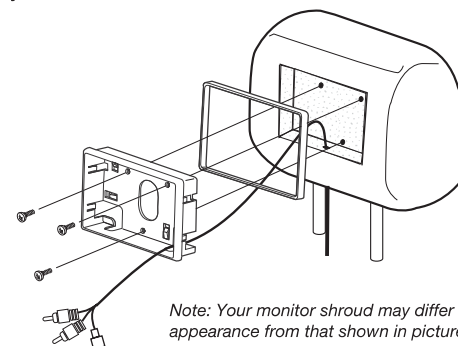

Note: Your monitor shroud may differ in appearance from that shown in picture.

NOTE: Headrests vary in their construction. Most headrests have a plastic plate inside into which you can directly attach the mounting screws. However, in some cases this plate is absent or is too deeply located for attachment. In this case, you may wish to cut a plate of wood of appropriate thickness and hot-glue it into place to use as a mounting plate.

Connect the RCA cables and the power cable, and slide the monitor into the shroud until you feel a click. As you do so, push the cables into the headrest shroud so they travel into the area behind the shroud and out below the headrest.

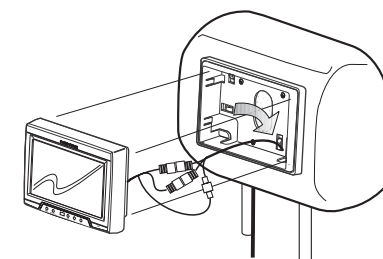

Monitor installation

CAUTION

If you have any doubts about this type of installation, please consult your local mobile electronics retailer. Making holes in the upholstery of your vehicle can cause damage which is expensive to repair.

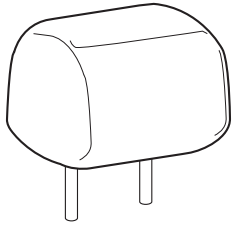

Carefully remove the headrest and set it down in an uncluttered work area. Take the appropriate precautions to ensure it is not damaged during installation.

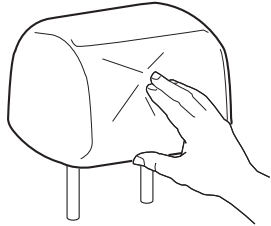

Push on the headrest with your fingers to make sure there are no obstructions inside that would interfere with the installation. After you confirm that there are no internal obstructions, take the paper template provided in place, and mark the area to be cut.

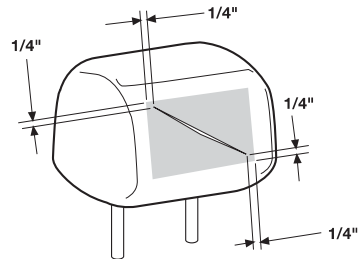

Using a sharp, adjustable-depth blade knife, make a diagonal cut beginning 1/4" INSIDE from one corner, and ending 1/4" INSIDE from the opposite corner.

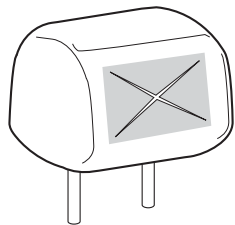

Repeat, cutting diagonally between the two other corners.

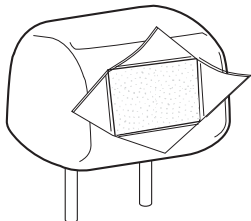

Carefully peel back the upholstery material.

Monitor Controls and Features

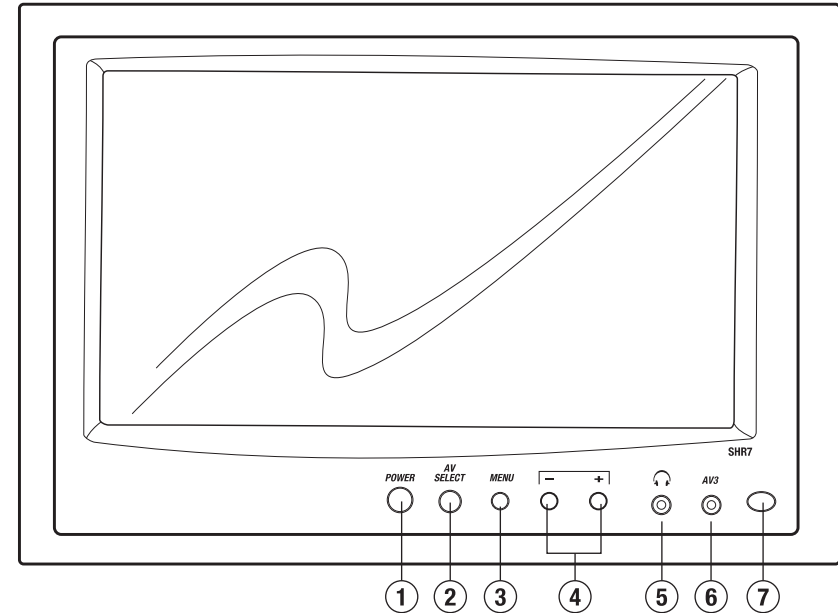

① POWER ON/OFF

This button turns the monitor system on and off.

② A/V SOURCE SELECTOR

Use this button to switch among A/V Source 1, A/V Source 2 and A/V Source 3.

③ MENU

This button enables the on-screen display menu system. Once enabled, this button is used as an ENTER button.

④ UP/DOWN BUTTONS

These buttons are used to increase or decrease parameters in the on-screen display menu system.

⑤ HEADPHONE JACK

Use for private listening.

⑥ AV INPUT 3

Additional AV input for such items as video games.

⑦ REMOTE IR SENSOR

Remote Control

- ① **AV1/AV2 (AV SOURCE SELECT)**
Use this button to switch between A/V Source 1 and A/V Source 2.
- ② **POWER**
Press to turn unit ON or OFF.
- ③ **MENU**
This button enables the on-screen display menu system. Once enabled, this button is used as an ENTER button.
- ④ **INCREASE/DECREASE BUTTONS**
These buttons are used to increase or decrease parameters in the on-screen display menu system.

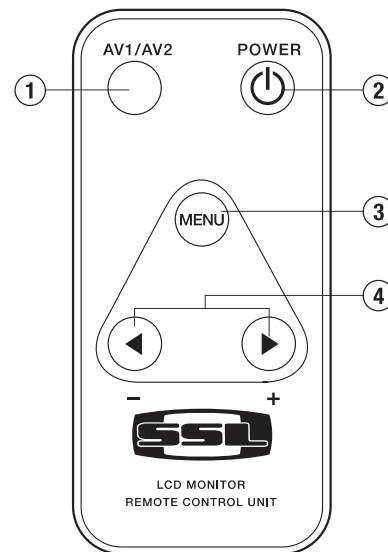

Changing the battery in the remote control

The remote battery is held in a small “drawer” on one edge of the remote. To open this drawer, press and hold the small button on the edge of this drawer (as shown below) and slide the drawer out.

Insert a new battery and push the drawer back fully into the remote.

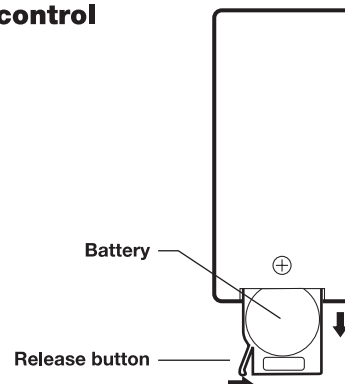

System wiring

On a towel or soft cloth, gently place the monitor assembly “face down” on a stable worksurface.

Using the wires provided, complete the audio, video and power connections in your vehicle as shown in the diagram below.

