



SOUND STORM®
LABORATORIES

SCD-550R



IN-DASH CD RECEIVER
WITH WIRELESS REMOTE CONTROL

USER'S MANUAL

INSTALLATION

Notes:

- Choose the mounting location where the unit will not interfere with the normal driving function.
- Before final installation, connect the wiring temporarily and make sure the unit and the system work properly.
- Use only the parts included with the unit to ensure proper installation. The use of unauthorized parts can cause malfunctions.
- Consult with your nearest dealer if installation requires the drilling of holes or other modifications of the vehicle.
- Install the unit where it does not get in the driver's way and cannot injure the passenger if there is a sudden stop, like an emergency stop.
- If installation angle exceeds 30° from horizontal, the unit might not give its optimum performance.

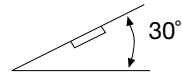

- Avoid installing the unit where it would be subject to high temperature, such as from direct sunlight, from hot air of the heater, or where it would be subject to dust, dirt or excessive vibration.

DIN FRONT/REAR-MOUNT

This unit can be properly installed either from “Front” (conventional DIN Front-mount) or “Rear” (DIN Rear-mount installation, utilizing threaded screw holes at the sides of the unit chassis). For details, refer to the following illustrated installation methods.

DIN FRONT-MOUNT (Method A)

Installation of the unit

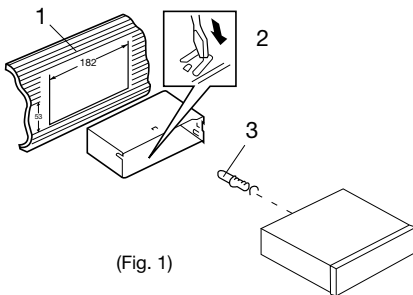

1. Dashboard
2. Mounting Bracket
After inserting the mounting bracket into the dashboard, select the appropriate tabs according to the thickness of the dashboard material and bend them outward to secure the holder in place.
3. Screw

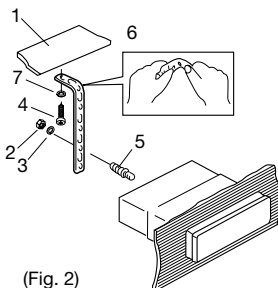

(Fig. 2)

Removing the unit

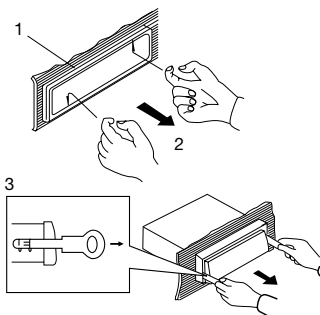

1. Dashboard
2. Nut (5mm)
3. Spring washer
4. Screw (5 x 25mm)
5. Screw (5 x 28mm)
6. Backstrap
Be sure to use the backstrap to secure the back of the unit in place. The strap can be bent by hand to the desired angle.
7. Plain washer

1. Frame
2. Insert fingers into the groove in the front of frame and pull out to remove the frame. (When reattaching the frame, point the side with grooves downward and attach it.)
3. Lever
Insert the levers supplied with the unit into the grooves at both sides of the unit as shown in figure until they click. Pulling the levers makes it possible to remove the unit from the dashboard.

DIN REAR-MOUNT (Method B)

Installation using the screw holes on the sides of the unit.

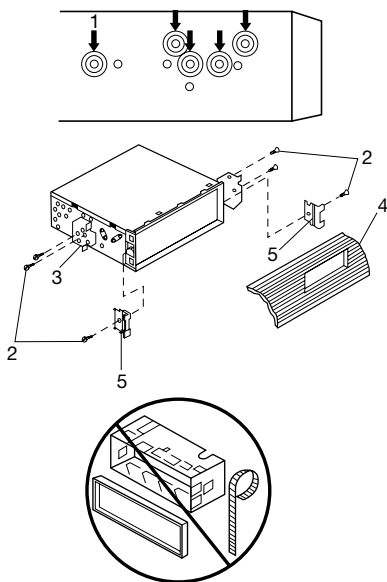

Fastening the unit to the factory radio mounting bracket.

1. Select a position where the screw holes of the bracket and the screw holes of the main unit become aligned (are fitted), then tighten the screws at 2 places on each side.
Use either truss screws (5 x 5mm) or flush surface screws (4 x 5mm), depending on the shape of the screw holes in the bracket.
2. Screw
3. Factory radio mounting bracket
4. Dashboard or Console
5. Hook (Remove this part)

Note: The trim piece, backstrap, and mounting bracket are not used for method B installation.

USING THE DETACHABLE FRONT PANEL

To Detach the Front Panel

1. Press the release button (REL), the front panel will drop down.

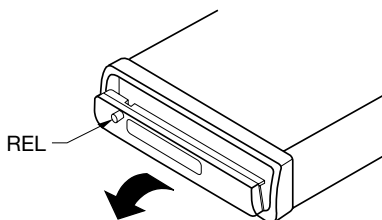

2. Remove the front panel by pulling it outward.

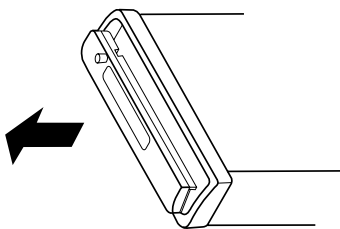

3. For safekeeping, store the front panel in the supplied protective case immediately after being removed.

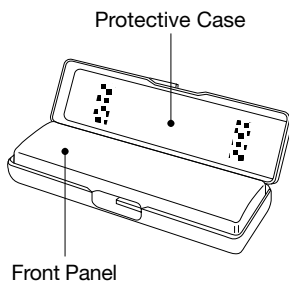

4. Push the front metal plate that holds the front panel into the main body. A 'click' sound should be heard.

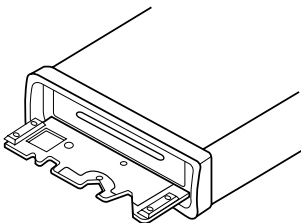

To Reinstall the Front Panel

1. Push the front panel into the main body. A 'click' sound should be heard.

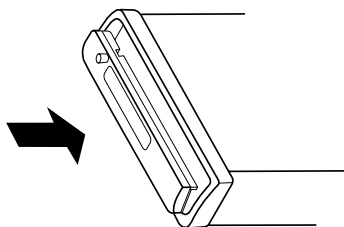

2. Note that if the front panel fails to lock in position properly, control buttons may not function and the display may be missing some segments. Push the release button and reinstall the front panel again.

Precautions when Handling

1. Do not drop the front panel.
2. Do not put pressure on the display or control buttons when detaching or reinstalling the front panel.
3. Do not touch the contacts on the front panel or on the main unit body. It may result in poor electrical contact.
4. If any dirt or foreign substances adhere to the contacts, they can be removed with a clean and dry cloth.
5. Do not expose the front panel to high temperatures or direct sunlight.
6. Keep away any volatile agents (e.g. benzene, thinner, or insecticides) from touching the surface of the front panel.
7. Do not attempt to disassemble the front panel.

WIRING CONNECTION

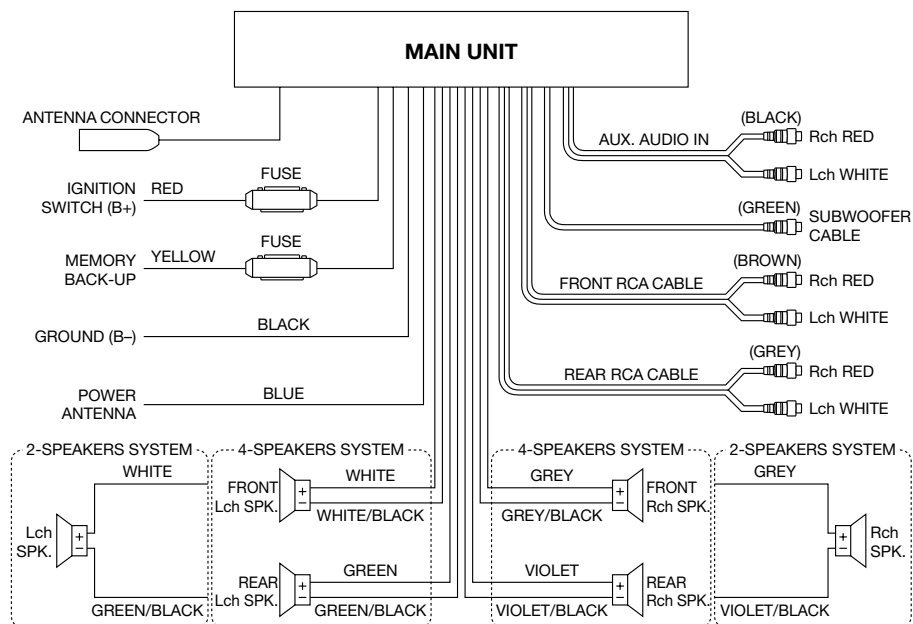

Note:

1. For 2-speakers system, green, violet, white/black and grey/black wire leads are unconnected and isolated.
2. For 2-speakers system, keep the fader indicator at center position to maintain the existing volume level.

OPERATION

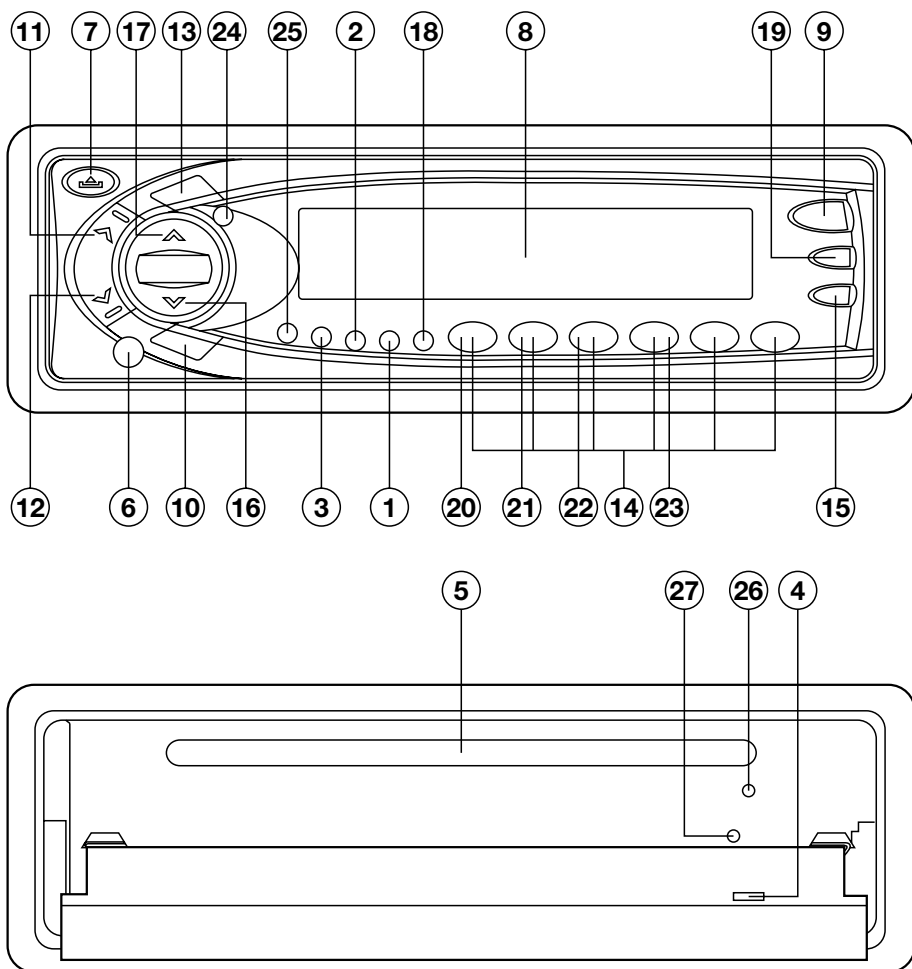

GENERAL OPERATION

• ON/OFF/ILLUMINATE

Switch on the unit by pressing any button [except **EJECT** button (4) and **REL** button (7)]. When system is on, press **ILL/PWR** button (9) shortly to control the brightness of VFD. Hold it for several seconds to turn off the unit.

• FACEPLATE RELEASE

Press **REL** button (7) to detach the removable faceplate.

• SOUND ADJUSTMENT

Press **SEL** button (10) to select the desired adjustment mode.

The adjustment mode will change in the following order.

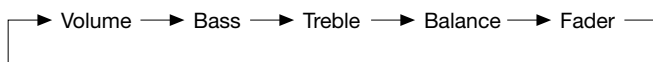

By pressing **VOL** \wedge button (11) or **VOL** \vee button (12), it is possible to adjust the desired level.

- **LOUDNESS**

Press **BND/LOU** button (13) for several seconds to reinforce the bass output. The display will show “**LOUD**”. Press it for several seconds again to defeat this function.

- **SET THE CLOCK**

Hold down the **DSP** button (15) until the clock is shown on the display and flashes. Then press the **TUNE/TRACK** \wedge button (17) to change hours or **TUNE/TRACK** \vee button (16) to change minutes.

- **SELECT MODE**

Press **MOD/SW** button (6) to choose desired listening mode.

- **SUBWOOFER**

Press **MOD/SW** button (6) for several seconds to toggle subwoofer output. When subwoofer is on, display will show “**SW**”. Press it again for several seconds to release this mode.

- **MUTE**

Press **MUT** button (3) to silence the receiver. Press it again to resume listening.

- **VACUUM FLUORESCENT DISPLAY**

Exhibit current frequency and activated functions on the display (8).

- **EQUALIZATION**

Press **EQ** button (19) to turn on equalization function and to select desired audio mode. There are five modes:

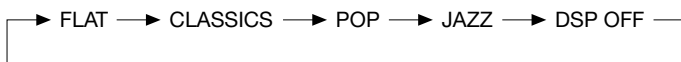

- **REMOTE SENSOR**

Point the remote control handset to the remote sensor **RX** (24). Press the function keys on the handset to control the system.

- **FLASHING LED**

If the front panel does not install in the unit, the **LED** (27) will flash.

- **RESET**

The **RESET** button (26) must be activated with either a ball point pen or thin pointed metal object. **RESET** button (26) is to be activated for the following reasons:

- Initial installation of the unit when all wiring is completed.
- All the function buttons do not operate.
- Error symbol on the display.

Note: If pressing the **RESET** button (26) doesn't work, please use a cotton swab soaked in isopropyl alcohol to clean the socket on the front panel.

RADIO OPERATION

• BAND SELECTION

For tuner mode, press **BND/LOU** button (13) briefly to select the desired band. The reception band will change in the following order:

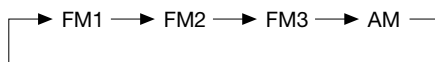

• STATION SELECTION

Press **TUNE/TRACK** Δ button (17) or **TUNE/TRACK** ∇ button (16) briefly to activate automatic seek function. Press for several seconds until **"MANUAL"** appears on the display. The manual tuning mode is now active. If both buttons have not been pressed for several seconds, they will return to "seek tuning" mode and **"AUTO"** will appear on the display.

• LOCAL/DISTANCE

Press **LOC** button (1) briefly to select between local and distant stations. "Local" setting is for reception of strong stations, and "distant" setting is for reception of weaker stations. This function is in during AUTO SEEK operation.

• AUTOMATIC MEMORY STORING & PROGRAM SCANNING

- Automatic Memory Storing

Press **AMS** button (18) for several seconds. The radio searches from the current frequency and checks the signal strength until one cycle search is finished. The 6 strongest stations are stored into the location corresponding to the preset buttons.

- Program Scanning

Press **AMS** button (18) briefly to scan preset stations. When the field strength level is more than the tuners threshold sensitivity level, the tuner will hold at that preset number for several seconds with muting released, then searches again.

• STATION STORING

Select a station. Then press any one of the preset buttons (14) (M1 to M6) to store a station into memory. Press this button for several seconds, the station is then stored into the number button.

• MONO/STEREO

Press **MONO** button (25) to select mono or stereo mode. You can sometimes improve reception of distant stations by selecting mono operation.

• SCAN

Press **SCAN** button (2) to set the function to scan mode. The tuner will stop at each station with a receivable signal and will stay tuned for several seconds, long enough to decide whether to stop at that station or to let the tuner continue to scan.

CD OPERATION

- **SELECT TRACKS**

During CD operation, press **TUNE/TRACK** ⏮ button (16) or **TUNE/TRACK** ⏭ button (17) to move to the previous track or the following track. Track number shows on the display.

During CD operation, hold **TUNE/TRACK** ⏮ button (16) or **TUNE/TRACK** ⏭ button (17) to fast reverse or fast forward. CD play starts from when you release the button.

- **PAUSE PLAYING**

Press **PAU** button (20) to pause CD player. Press it again to resume play.

- **REPEAT THE SAME TRACK**

During CD operation, press **RPT** button (22) to continuously repeat the same track. Press again to stop repeat.

- **PREVIEW ALL TRACKS**

During CD operation, press **SCN** button (21) to play first several seconds of each track on the current disc. Press again to stop intro and listen to track.

- **PLAY ALL TRACKS**

During CD operation, press **SHF** button (23) to play all tracks on CD in random order. Press again to cancel the function.

- **EJECT**

Press **EJECT** button (4) to stop CD play and eject the disc from the slot (5).

NOTE ON CD-R/CD-RW DISCS

- On this unit, in addition to an audio CD, you can play your original CD-R or CD-RW discs that contain audio titles.
- However, depending on the condition of the recording equipment or the CD-R or CD-RW itself, some CD-Rs or CD-RWs may not play in this unit.
- DO NOT stick paper or tape, etc, onto label side or the recorded side of any CD-R/CD-RW, as it may cause a malfunction.

REMOTE CONTROL HANDSET

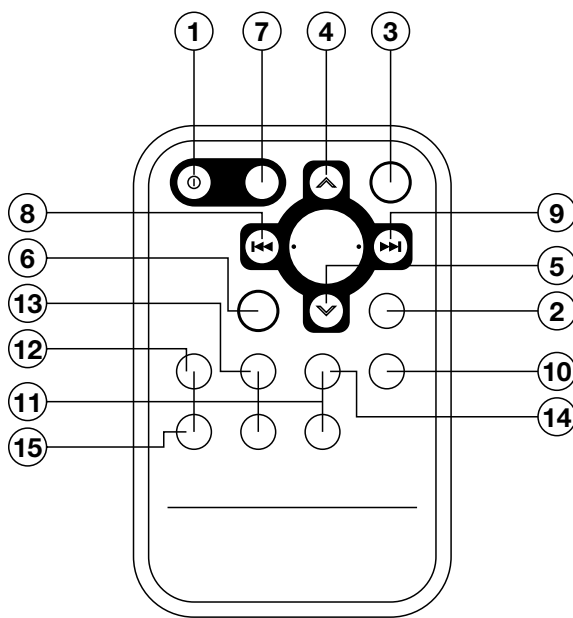

FUNCTION KEYS & CONTROL

- | | |
|-----------------|--|
| 1. PWR | = Power ON/OFF Button |
| 2. DSP | = Display Button |
| 3. SEL | = Select Button |
| 4. VOL ▲ | = Volume Up Button |
| 5. VOL ▼ | = Volume Down Button |
| 6. BND | = Band Select Button |
| 7. MOD | = Mode Button |
| 8. TUNE/SEEK ◀◀ | = Tune/Seek Down Button |
| 9. TUNE/SEEK ▶▶ | = Tune/Seek Up Button |
| 10. AMS | = Automatic Memory Storing & Program Scanning Button |
| 11. M1 - M6 | = Preset Buttons |
| 12. PAU | = Pause Button |
| 13. SCN | = Scanning Button |
| 14. RPT | = Repeat Button |
| 15. SHF | = Shuffle Button |

SPECIFICATION

GENERAL

Power Supply Requirements	: DC 12 Volts, Negative Ground
Chassis Dimensions	: 178 (W) x 165 (D) x 50 (H) mm 7" x 6.1" x 1.9"
Tone Controls	
- Bass (at 100 Hz)	: + 10 dB / - 10 dB
- Treble (at 10 KHz)	: + 10 dB / - 10 dB
Maximum Output Power	: 60W x 4 (ch)
Current Consumption	: 5 Amperes
Weight	: 2 KG 4.4 lb

CD PLAYER

Signal to Noise Ratio	: More than 60 dB
Channel Separation	: More than 60 dB
Frequency Response	: 20 Hz - 20 KHz

RADIO

	FM
Frequency Coverage	: 87.5 to 107.9 MHz
IF	: 10.7 MHz
Sensitivity (S/N = 30 dB)	: 3 μ V
Stereo Separation	: > 30 dB

	AM
Frequency Coverage	: 530 to 1710 KHz
IF	: 450 KHz
Sensitivity (S/N = 20 dB)	: 32 dBu

TROUBLE SHOOTING

Before going through the check list, check wiring connection. If any of the problems persist after check list has been made, consult your nearest service dealer.

Symptom	Cause	Solution
No power.	The car ignition switch is not on.	If the power supply is properly connected to the car accessory circuits, but the engine is not running, switch the ignition key to "ACC".
	The fuse is blown.	Replace the fuse.
Disc cannot be loaded or ejected.	Presence of disc already inside the player.	Remove the disc in the player, then put a new one in.
	Inserting the disc in reverse direction.	Insert the compact disc with the label facing upward.
	Compact disc is extremely dirty or scratched.	Clean the disc or replace with a new one.
	Temperature inside the car is too high.	Cool off until the ambient temperature returns to normal.
	Condensation.	Leave the player off for an hour or so, then try again.
No sound.	Volume is too low.	Adjust volume to a desired level.
	Wiring is not properly connected.	Check wiring connection.
Sound skips.	The installation angle is more than 30 degrees.	Adjust the installation angle less than 30 degrees.
	The disc is extremely dirty or defective.	Clean the compact disc, then try to play again.
The operation keys do not work.	The built-in microcomputer is not operating properly due to noise.	Press the RESET button. Front panel might not be properly fixed into its place.
The radio does not work. The radio station automatic selection does not work.	The antenna cable is not connected.	Insert the antenna cable firmly.
	The signals are too weak.	Select a station manually.



3451 LUNAR COURT
OXNARD, CA. 93030
www.soundstormlab.com

Phone: 805.983.8008

Fax: 805.983.7068

Technical questions: ssltech@soundstormlab.com